

J:\CHICAGO\31-009494-10-ST_ELIZABETH_CDS_AESDC_CRITICAL_EXAMPLEPROPERTY OF THE OFFICE OF THE GENERAL COUNSEL OF ASCENSION
CONFIDENTIAL ASSESSMENT\N AT ASCENSION\ACAD\9494-SH501.DWG 4/1/2024 7:34:48 AM PEREZ, JOSE A

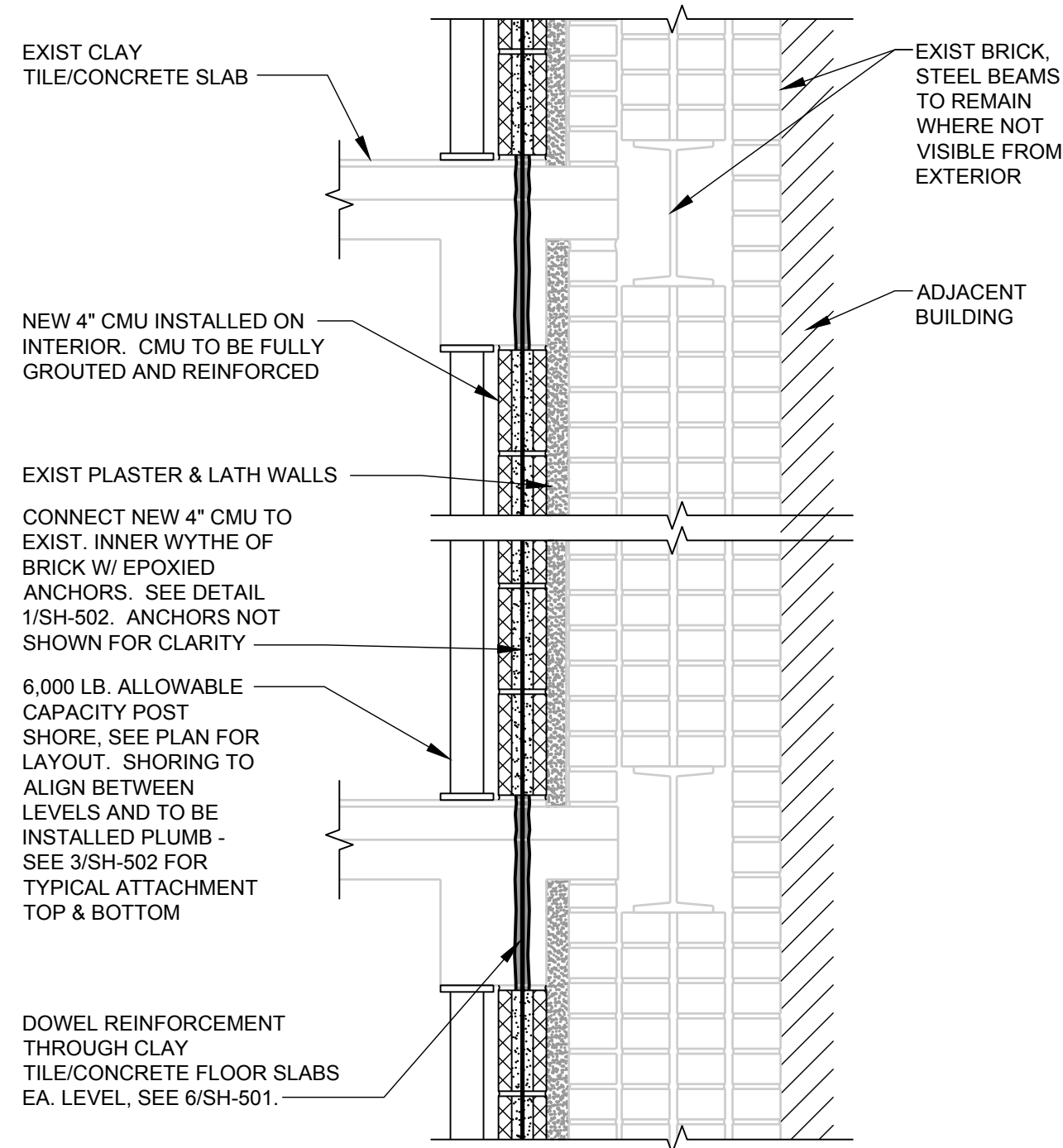

NEW CMU/EXISTING BRICK WALL SECTION

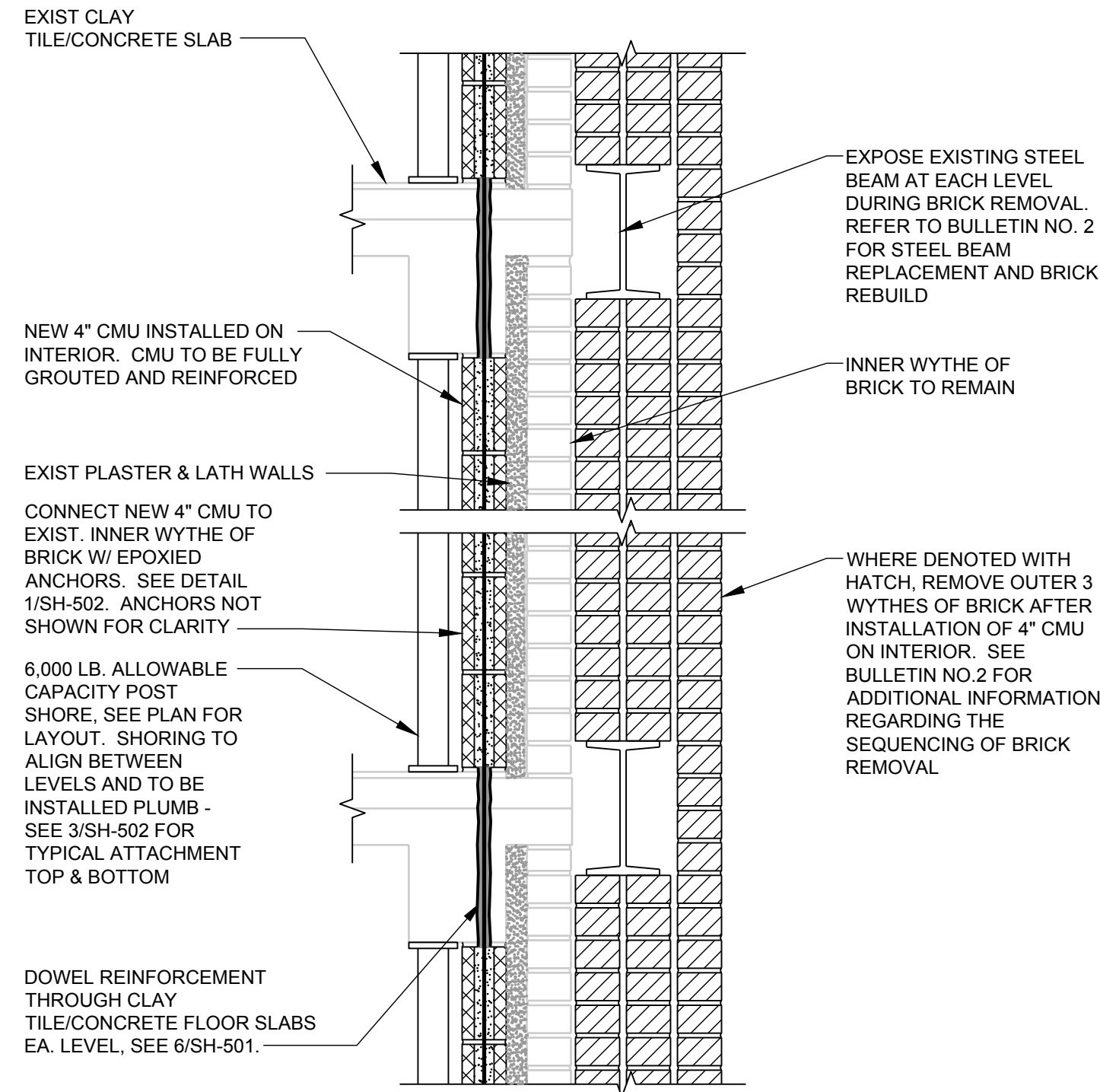

NEW CMU/EXISTING BRICK WALL SECTION

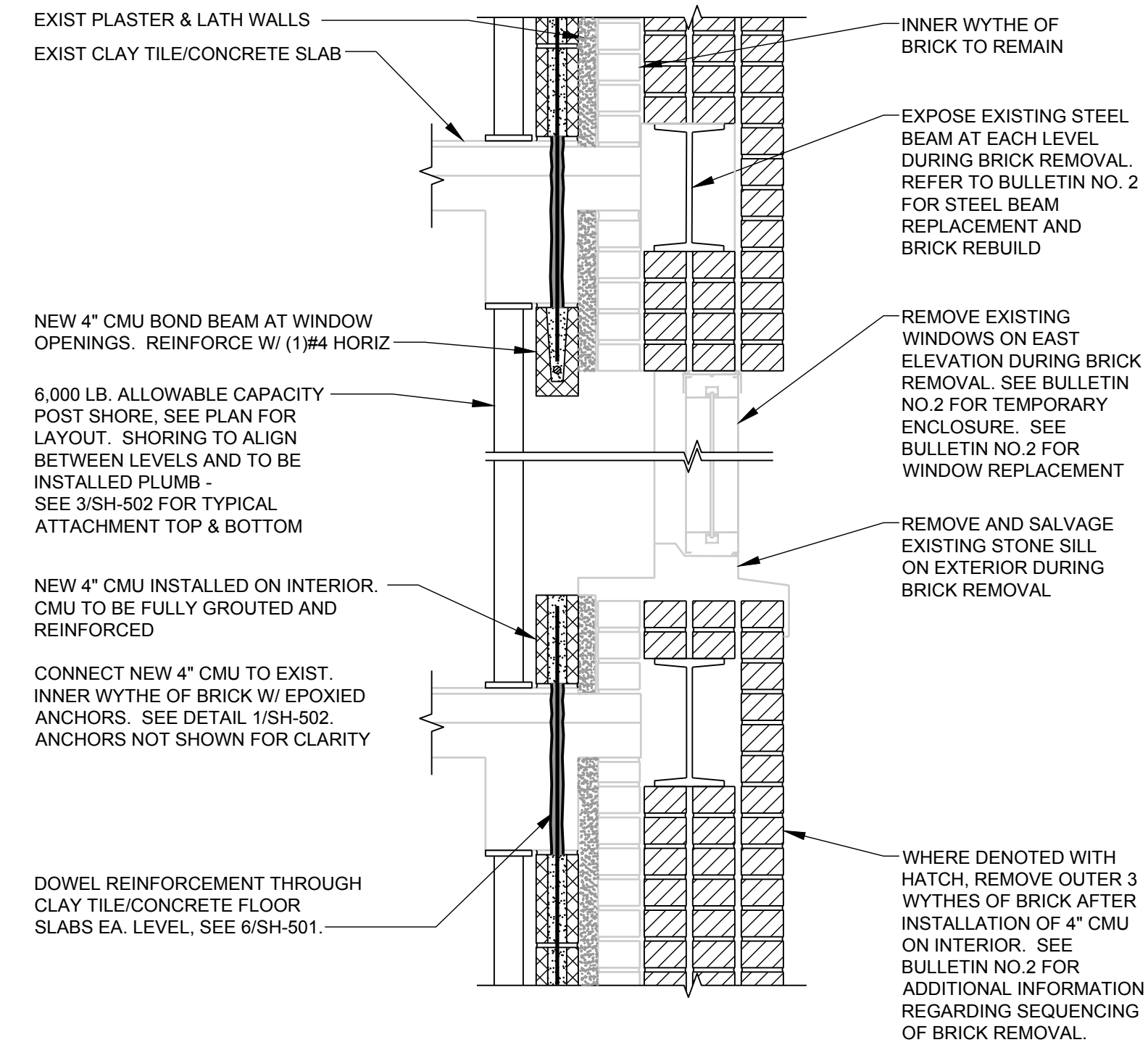

NEW CMU/EXISTING BRICK WALL SECTION

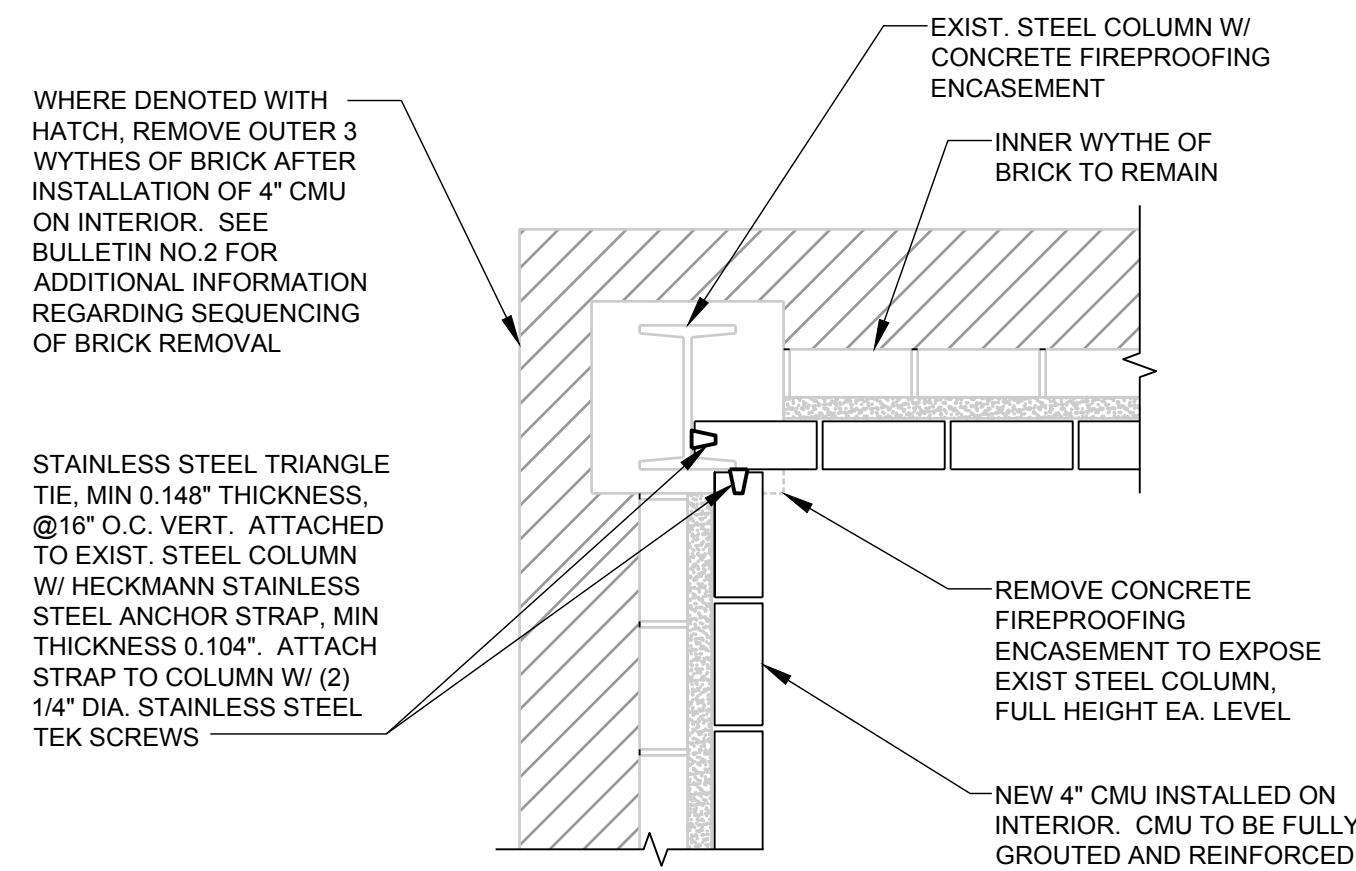

NEW CMU / EXISTING COLUMN SECTION

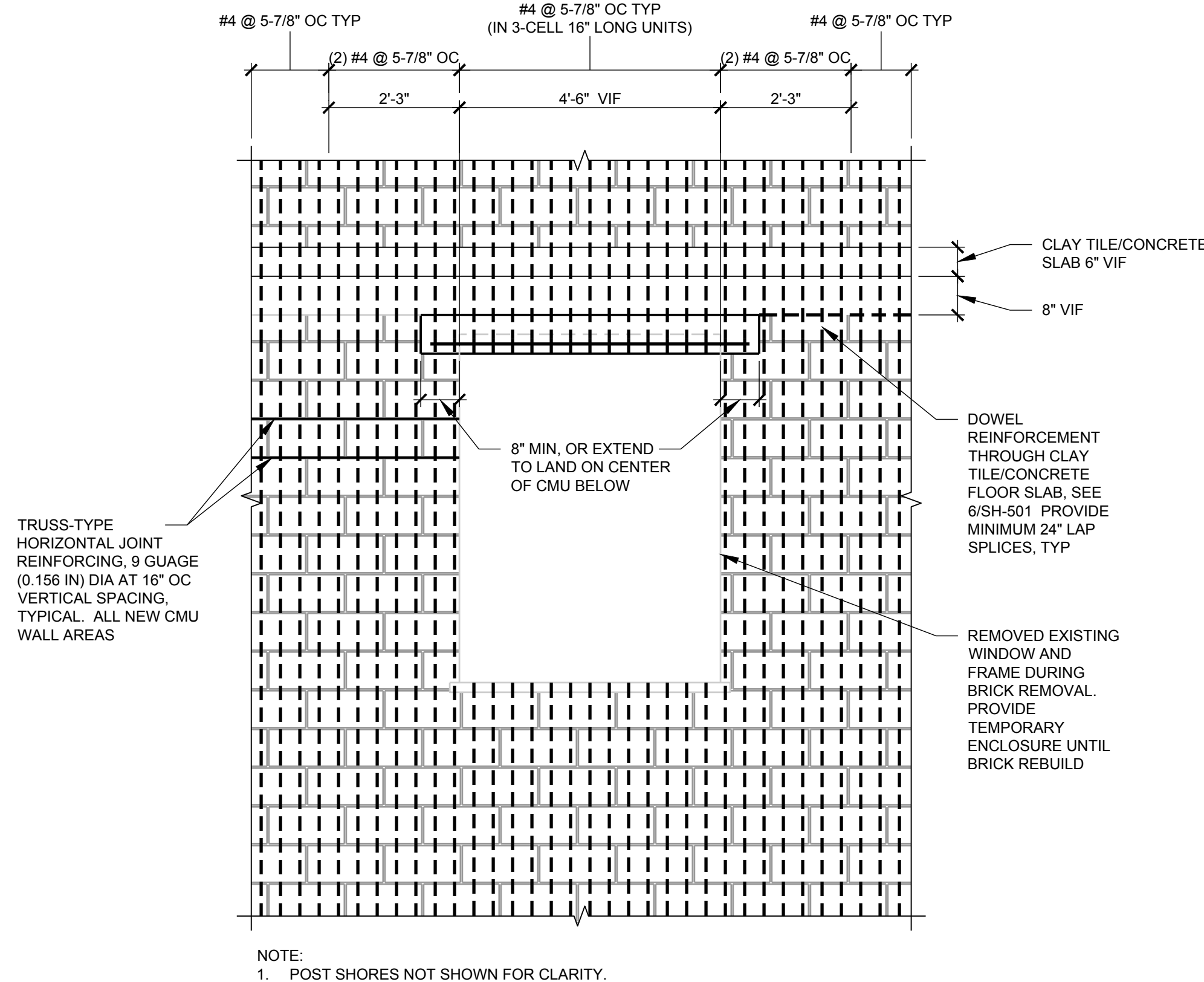

NEW CMU ELEVATION

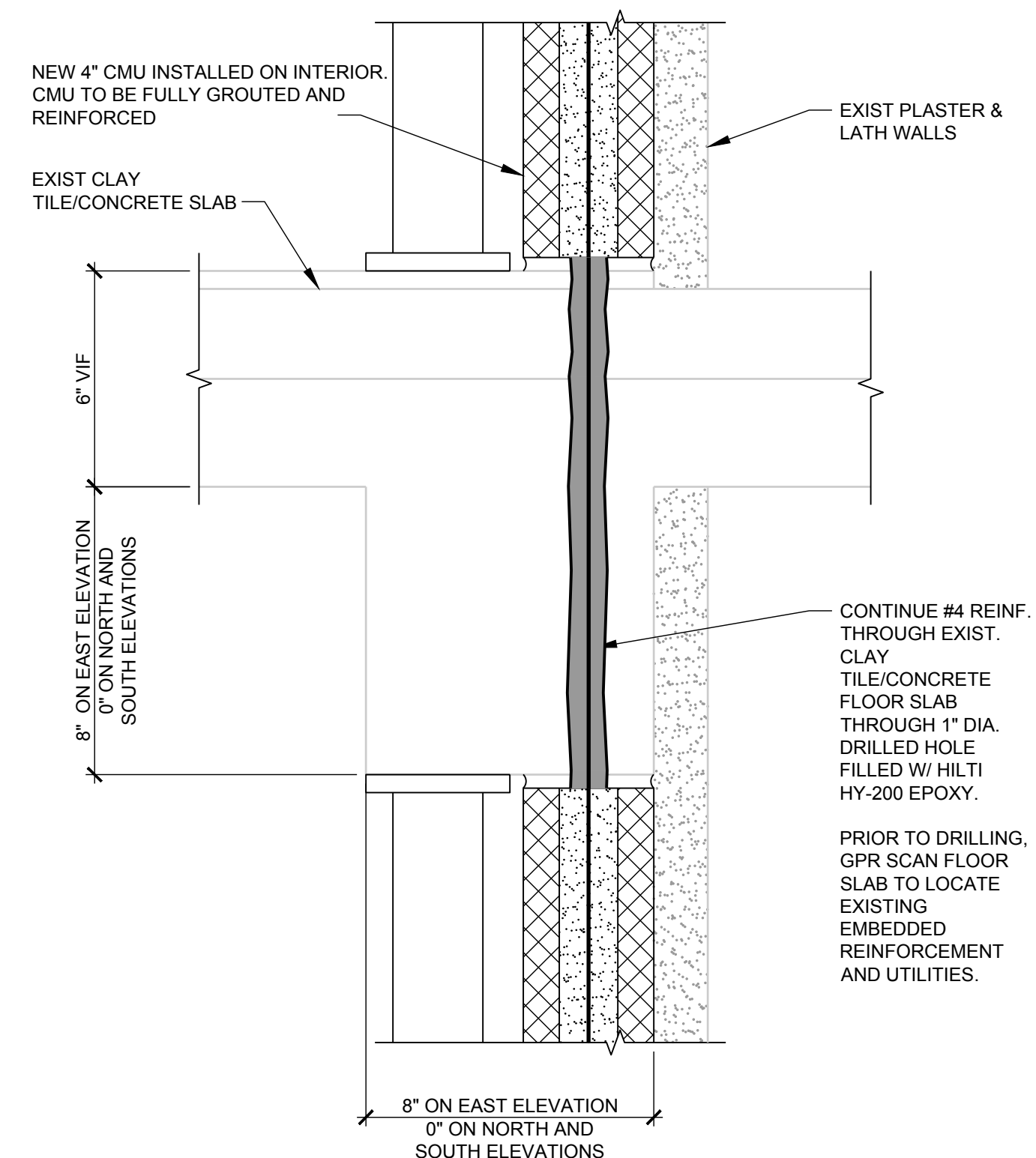

REINFORCEMENT DOWELING SECTION

CHICAGO, ILLINOIS

REVISIONS		ISSUE:	BULLETIN No.1
MARK	DATE	DESCRIPTION	
2	04/01/2024		BULLETIN No.1
1	02/21/2023		BID CLARIFICATIONS

COPYRIGHT © 2024. ALL RIGHTS RESERVED.
NO PART OF THIS DOCUMENT MAY BE REPRODUCED
IN ANY FORM OR BY ANY MEANS WITHOUT
PERMISSION FROM WALKER CONSULTANTS.

SHEET TITLE:
SHORING DETAILS